

MIS Tracking Installation Instructions

This kit contains complete instructions for installation and setup of the MIS Tracking System.

Call for Activation and Technical Support: 401-247-7780

Equipment List



- A 3' Fiberglass Aviation Antenna
- B 4' Fiberglass Aviation Antenna
- C 3' Wire Whip Tram Antenna
- D 2 Soft Install Test Antennae
- E MIS Receiver
- F Power Supply
- G 1 10' CAT5 Cable
- H 3 50' Cables
- I 2 Multi-Brackets (pre-attached)
- J 1 "L" Bracket (pre-attached)
- K 4 U-Bolts, Washers, Nuts

Equipment Specifications

A 3' Fiberglass Aviation Antenna
Frequency 1090 MHz, has a bracket / pole mount fitting of 6.35cm by 6.1cm = 2-1/2in by 2-3/8in. (36 in)

B 4' Fiberglass Aviation Antenna
Frequency 978 MHz, has a bracket / pole mount fitting of 6.35cm by 6.1cm = 2-1/2in by 2-3/8in. (48 in)

C 3' Wire Whip Tram Antenna
(6dB performance) stainless steel "L" bracket 4.2 cm / 6.7cm = 2-5/8in / 1-5/8in approx. (36 in)

D Soft Install Test Antennae
868MHZ/915MHZ / GSM / 3G Small Omnidirectional High-gain Antenna (7DBI)

E Receiver Dimensions
Width = 5 inches / 12.7 cm,
Length = 8 3/4 inches / 22.225 cm
Height = 2 1/4in / 5.715 cm)

F Power Supply:
Model DSA 12CA-05 -Output +5V-2A
/ Input 100-240V~50/60Hz 0.3A

Antennae Mounting

Brackets are included for flush or pole and stantion mounting of antennae.

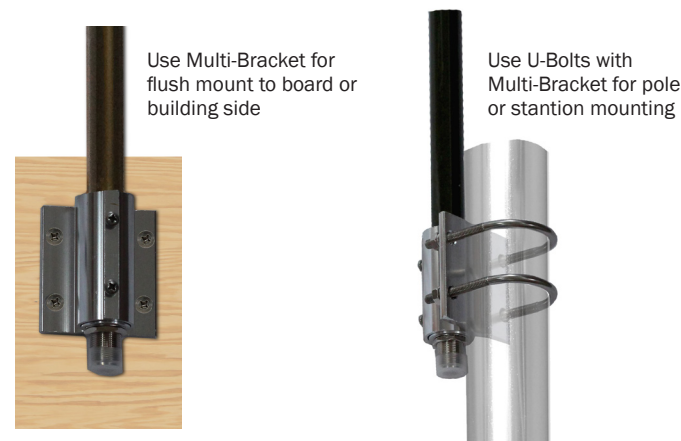

Receiver Wiring

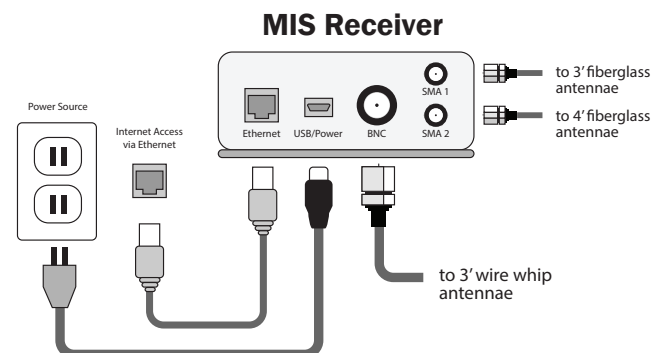

Activating the System

After installation, call MIS for system activation at: **401-247-7780**

